

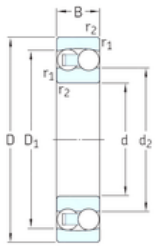

# Xili Bearing Co., Ltd



Cylindrical bore



Tapered bore

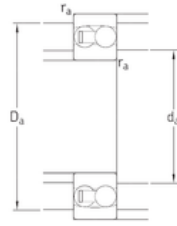

## 65 mm x 140 mm x 33 mm SKF 1313EKTN9 self aligning ball bearings

Bearing No. 1313EKTN9

1313EKTN9 Bearing 2D drawings and 3D CAD models

Size	65x140x33 mm
Bore Diameter	65 mm
Outer Diameter	140 mm
Width	33 mm
d	65 mm
D	140 mm
B	33 mm
C	33 mm
d2	99 mm
r1 min.	2,1 mm
r2 min.	2,1 mm
D1	127 mm
da min.	77 mm
Da max.	128 mm
ra max.	2 mm
Weight	2,45 Kg
Basic dynamic load rating (C)	65 kN
Basic static load rating (C0)	25,5 kN
Fatigue load limit (Pu)	1,25
Reference speed	8500 r/min
Limiting speed	6000 r/min
Calculation factor (e)	0,22
Calculation factor (kr)	0,04
Calculation factor (Y0)	2,8
Calculation factor (Y1)	2,9



**Xili Bearing Co., Ltd**